

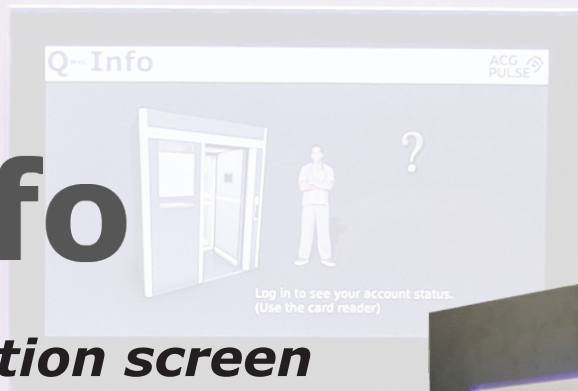

Q^{Web} Info

User Information screen



 **Items on user's account**

 **Accessible items**

 **Items in use**

 **Time limit**

 **Purchase & Lease**

options

Description

Q-Web Info is used to show the user's account and to see which articles you have access to.

The product consists of a screen and a card reader. The card reader is for scanning the user's card, thereafter the information is displayed on the screen.

Q-Info



Dimensions (mm)

Width 500
Depth 78
Height 700
Weight 9kg

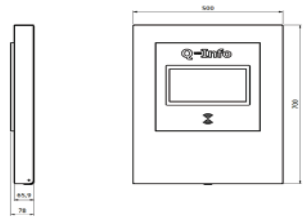

The screen

Sven Svensson		ACG PULSE	
Article description	Preferred size	Items in use	Oldest item in use date
T-shirt White		1	2022-07-08
Buff Acg Pulse		0	
Calculator		0	
Car key Alfa Romeo		0	

Upon scanning your card, the display will show what kind of articles the user has linked to the user account. The screen will show:

- Article description
- Preferred size
- Items in use
- Oldest item in use

Easy installation/ connection

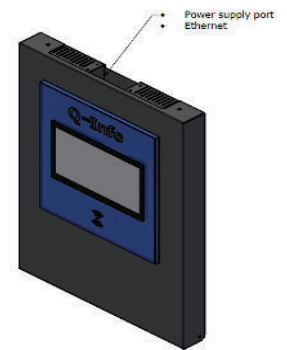

Q-Web[®]

Description

In our user-friendly web interface Q-Web[®], it is simple to manage and administer users, items and statistics.

The statistics pages give an overview of demand, current status, and expected frequency of use.

Moreover, the software is customizable to suit customer requirements.

Q-Web[®]

Q-Web[®] is a web-based logistics program for item management for the Q-Web[®] Products.

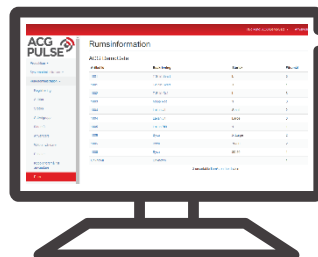

UniTech Contact

Adam Wearing

Mob: 07950 477992

Email: awearing@unitechgb.com

Jon Walter

Mob: 07950 477990

Email: jwalter@unitechgb.com